

## ECOTEST COVID-19 ANTIGEN TEST PROCEDURE

The COVID-19 Antigen Rapid Test Device is used to detect SARS-CoV-2 viral antigens. Antigen testing will show the current COVID-19 status of a donor. Please ensure you familiarise yourself with the collection procedure before administering this test and wear correct PPE.

If a positive result is obtained please ensure Local Government and Healthcare Guidelines are strictly adhered to.

### Collecting the sample

#### ► Oropharyngeal swab (OP swab)

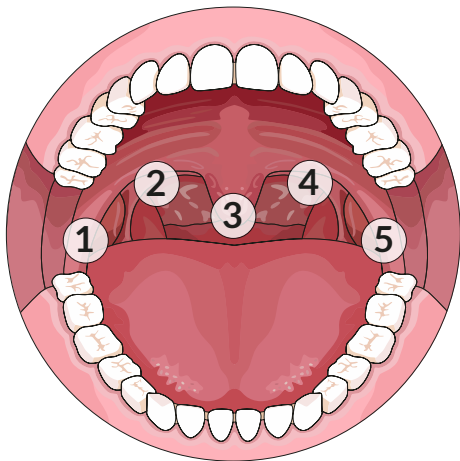

1. Remove the swab from its packaging
2. Insert the swab completely via the mouth into the throat. Collect sample in 5 key areas shown by rubbing swab against these areas moderately. **Good sample collection is important.** Avoid touching the tongue at all times.
3. Remove swab and follow test procedure

OR

#### ► Nasopharyngeal swab (NP swab)

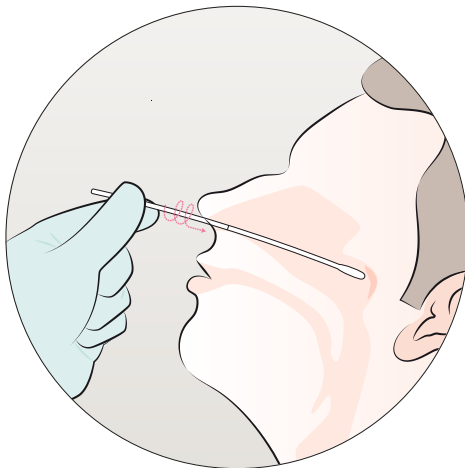

1. Remove the swab from its packaging
2. Tilt head back and gently insert the swab into the nasal passage until resistance is felt (please see picture)
3. Rotate swab against the nasal wall for 10 seconds (this ensures the swab contains cells as well as mucus)
4. Remove swab and follow test procedure

Any questions? Call +44 (0) 1554 788200

## ECOTEST COVID-19 ANTIGEN TEST PROCEDURE

### ► Test Procedure

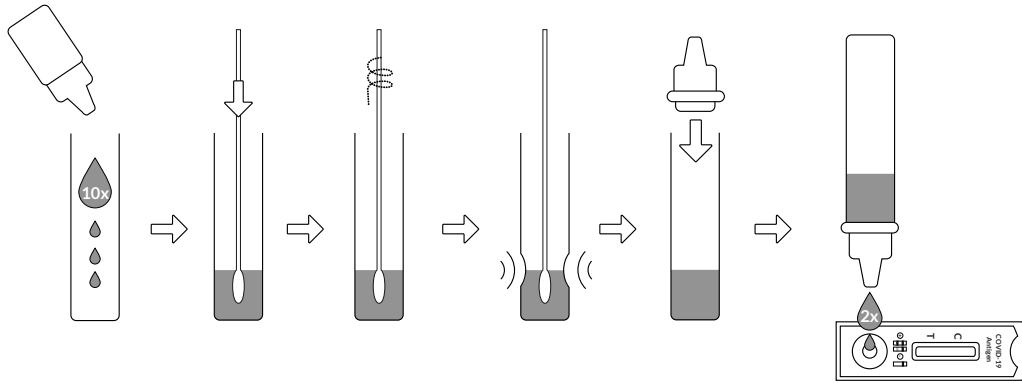

Bring devices, reagents and specimens and/or controls to room temperature (15~30°C) before use.

1. For each specimen, open the foil pouch just before testing and remove the test device, and put it on a clean, level surface. Label the tube with the patient identification.
2. For best results, the assay should be performed within one hour.
3. Gently mix extraction buffer. Add **EXACTLY 10 DROPS** into the extraction tube.
4. Insert the swab into the extraction tube. Mix well and **SQUEEZE THE SWAB 10-15 TIMES** by compressing the walls of the tube against the swab.

**STAND FOR 2 MINUTES. - VERY IMPORTANT**

5. Roll the swab head against the inner wall of the tube as you remove it. Try to release as much liquid as possible. Dispose of the used swab in accordance with your biohazard waste disposal protocol.
6. Insert filter cap into sample extraction tube. Invert the tube and add **2 DROPS OF SOLUTION** into the sample well by gently squeezing the tube.

**READ RESULTS AT 15 MINUTES**

### ► Interpretation of Results

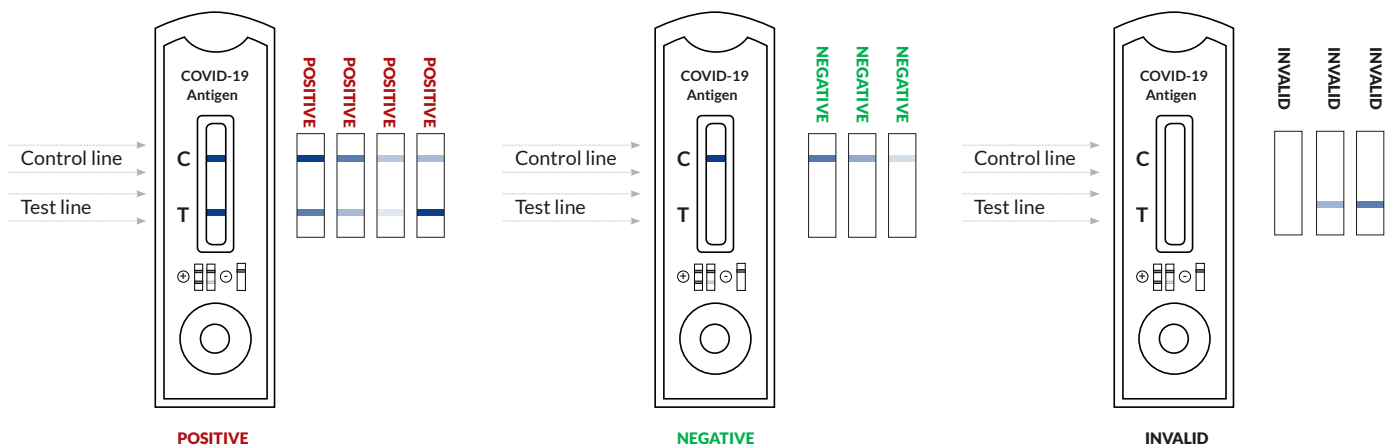

POSITIVE

NEGATIVE

INVALID